



The Hawthorns, Ongar, CM5

BUTLER & STAG



Welcome to The Hawthorns, Fyfield a stunning collection of 23 beautifully designed new homes, perfectly located in the picturesque village of Fyfield, Essex. A range of thoughtfully crafted three, four, and five-bedroom detached and semi-detached homes are available, each built to an exceptional standard and finished with premium specifications throughout.



Freehold

- Exclusive New Build Development - 3, 4 & 5 detached and semi-detached homes.
- The Harrow - five bedroom, three bathroom home finished to a premium standard.
- Open-plan kitchen/dining space with quartz countertops & bespoke design.
- Underfloor heating to ground floor & bathrooms.

The Harrow - These beautifully designed, detached homes are two exclusive properties on the development, each offering five bedrooms across three floors with stylish contemporary features throughout.

Upon entry, you're greeted by a large entrance hall, setting the tone for the rest of the property. To the left, the spacious living room is a bright, welcoming space, featuring pelmet mood lighting that adds an extra touch of sophistication.

At the heart of the home lies the open-plan kitchen and dining area, featuring a large island, which provides a fantastic space for entertaining, while the double doors open to a beautifully landscaped private garden. The garden extends to the rear of the property, offering generous outdoor space for relaxing, entertaining, or play. A convenient downstairs WC completes the ground floor.

The first floor opens onto a spacious landing leading to three well-proportioned bedrooms. The main bedroom features built-in wardrobes and a luxurious en suite. Two additional double bedrooms and a stylish family bathroom complete this level, along with a generous storage cupboard.

On the top floor, you'll find another double bedroom and a versatile fifth bedroom - perfect as a guest room, children's bedroom, or home office. A contemporary shower room completes the accommodation on this floor.

The property benefits from two allocated parking spaces - one located under a car port (complete with an Electric Vehicle Charging Point) and another additional off-road parking space.

The development is situated on the perimeter of this highly regarded country village,





The Harrow

Approx. Gross Internal Area 1650 sq M (1650 sq Ft)

BUTLER & STAG

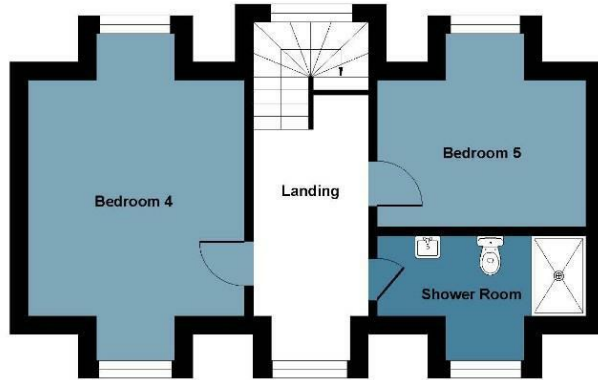

Second Floor



Ground Floor

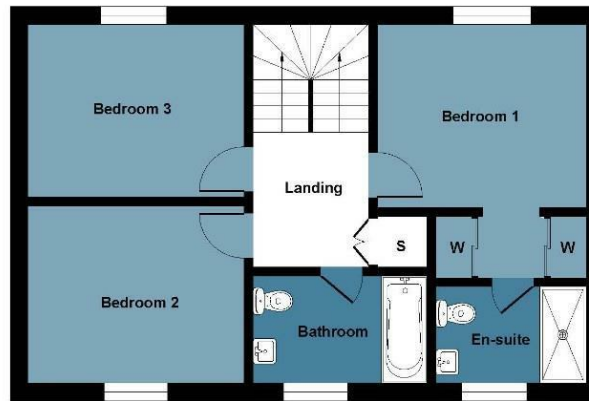

First Floor

Measurements are approximate and for illustration purposes only, while we do not doubt the accuracy and completeness, we advise you conduct independent assessment of the property to determine monetary value.
© @ modephoto.uk www.modephoto.co.uk

BUTLER & STAG

☎ 01992 667666

🏠 4 Forest Drive, Theydon Bois, Essex, CM16 7EY

✉ theydon@butlerandstag.com

IMPORTANT NOTICE - These particulars have been prepared in good faith and they are not intended to constitute part of an offer or contract. We have not performed a structural survey on this property and the services, appliances and specific fittings have not been tested. All photographs, measurements, floor plans and distances referred to are given as a guide and should not be relied upon.

www.butlerandstag.uk